

1-1-1998

Floor Plan Gallery X

Gallery X

Follow this and additional works at: https://digitalcommons.ric.edu/as220_root



Part of the [Arts and Humanities Commons](#)

Recommended Citation

Gallery X, "Floor Plan Gallery X" (1998). *AS220 Digital Archive*. 109.
https://digitalcommons.ric.edu/as220_root/109

This Article is brought to you for free and open access by Digital Commons @ RIC. It has been accepted for inclusion in AS220 Digital Archive by an authorized administrator of Digital Commons @ RIC. For more information, please contact digitalcommons@ric.edu.

Richard,

Here's the floor plan and layout for the card. What time do you usually have receptions? I'll talk to you more in regards to hanging, etc.

Thanks George

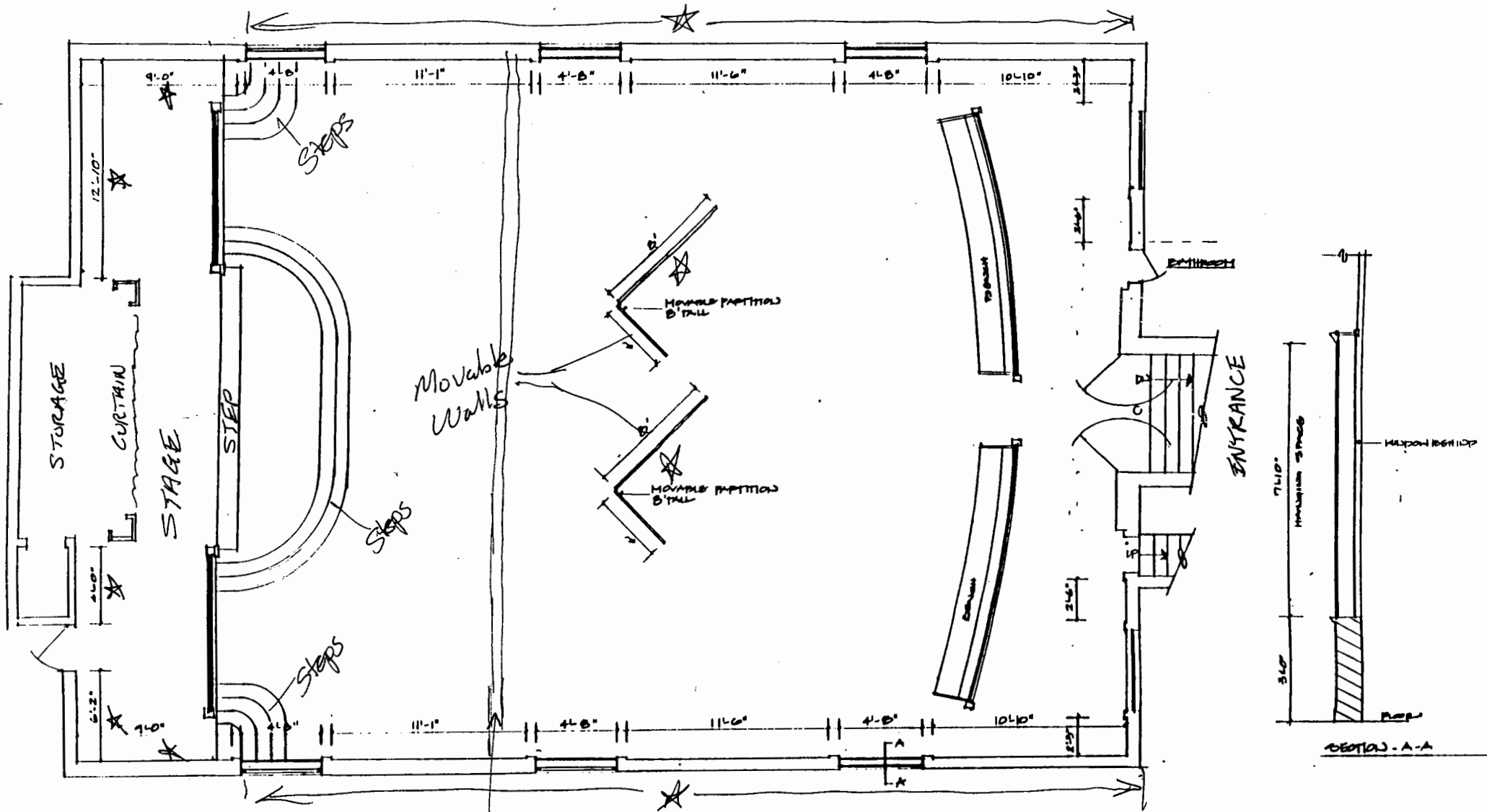

FLOOR PLAN - GALLERY X

Pipe 20'
above floor
level for
hanging stage
lighting or
3D works

★ AREAS WERE WORK
CAN BE HUNG.

Ceiling height
28'
Usable wall height
10'